

234 ROD COUPLING

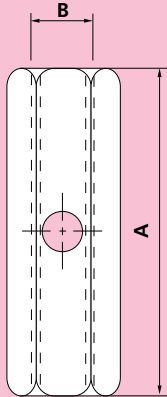

Material: Carbon Steel

PART NUMBER	ROD SIZE B	LENGTH A	SIGHT HOLE Ø	WEIGHT kgf	LOAD CAPACITY		LOAD GROUP
					kgf	kN	
F234M08	8	30	6	0.04	230	2.3	0
F234M10	10	30	6	0.04	360	3.5	1
F234M12	12	36	6	0.06	530	5.2	2
F234M16	16	50	8	0.1	1010	9.9	3
F234M20	20	60	10	0.2	1580	15.5	4
F234M24	24	70	12	0.4	2280	22.4	5
F234M30	30	90	12	0.8	3650	35.8	6
F234M36	36	110	12	1.4	5340	52.4	7
F234M42	42	120	14	2.1	7400	72.6	8
F234M48	48	130	14	3.2	9650	94.6	9
F234M56	56	160	14	4.9	13350	130.9	10
F234M64	64	190	14	6.9	18000	176.5	11
F234M72	72	210	14	9.7	23025	225.8	12
F234M80	80	230	14	13.1	28125	275.8	13