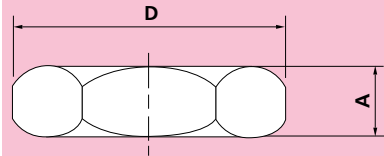
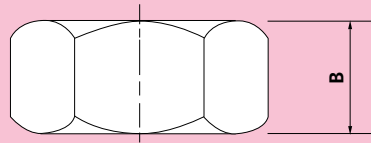
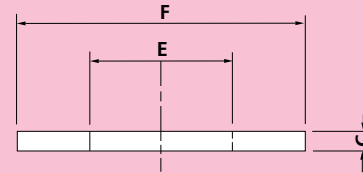

277 LOCKNUT*Material: Carbon Steel***278 FULL NUT***Material: Carbon Steel***279 FLAT WASHER***Material: Carbon Steel*

LOCKNUT PART NUMBER	FULL NUT PART NUMBER	FLAT WASHER PART NUMBER	THREAD SIZE	A	B	C	D	E	F	LOAD GROUP	WEIGHTS kgf		
											LOCKNUT	FULL NUT	WASHER
F277M08	F278M08	F279M08	M8	5	6.5	1.6	15	9	17	0	0.004	0.005	0.002
F277M10	F278M10	F279M10	M10	6	8.0	2.0	20	11	21	1	0.009	0.011	0.004
F277M12	F278M12	F279M12	M12	7	10.0	2.5	22	14	24	2	0.011	0.016	0.006
F277M16	F278M16	F279M16	M16	8	13.0	3.0	28	18	30	3	0.019	0.031	0.011
F277M20	F278M20	F279M20	M20	9	16.0	3.0	35	22	37	4	0.034	0.061	0.016
F277M24	F278M24	F279M24	M24	10	19.0	4.0	42	26	44	5	0.054	0.104	0.031
F277M30	F278M30	F279M30	M30	12	24.0	4.0	53	33	56	6	0.105	0.211	0.051
F277M36	F278M36	F279M36	M36	14	29.0	5.0	64	39	66	7	0.181	0.374	0.088
F277M42	F278M42	F279M42	M42	16	34.0	7.0	75	45	78	8	0.285	0.606	0.150
F277M48	F278M48	F279M48	M48	18	38.0	8.0	87	52	92	9	0.440	0.928	0.284
F277M56	F278M56	F279M56	M56	22	45.0	9.0	99	62	105	10	0.675	1.380	0.399
F277M64	F278M64	F279M64	M64	24	51.0	9.0	110	70	115	11	0.876	1.861	0.463
F277M72	F278M72	F279M72	M72	28	58.0	10.0	120	78	125	12	1.023	2.197	0.569
F277M80	F278M80	F279M80	M80	32	64.0	12.0	131	86	140	13	1.324	2.825	0.781