

## C-CLAMP WITH LOCKING NUT

Figure 47

Figure 47SS (Stainless Steel)

## C-CLAMP WITHOUT LOCKING NUT

Figure 238

The Figure 47 is designed to attach to the bottom flange of a steel beam. A locking nut is provided and when tightened prevents loosening due to vibration.

The Figure 238 is identical to the Figure 47 and may require a Figure 22 Retaining Clip to prevent loosening due to vibration.

Install both Figure 47 and 238 in accordance with MSS-SP69 set screw torque values.

Maximum loads are based upon full thread engagement by the rod.

Some Codes require the use of a Figure 22 Retaining Clip on all C-Clamps. When using a Retaining Clip the maximum allowable flange thickness is reduced by 1/8".

**Material:** Carbon Steel with Hardened Steel Cup Point Set Screw. Stainless Type 304.

**Compliance:** Federal Specification A-A-1192A Type 23, MSS-SP-69 Type 23.

**Finish:** Plain, Painted, Electro-Galvanized. Figure 47SS (Sizes 3/8", 1/2", 5/8").

**Ordering:** Specify rod size, figure number, and finish. For Metric applications specify Figure M47 or Figure M238.

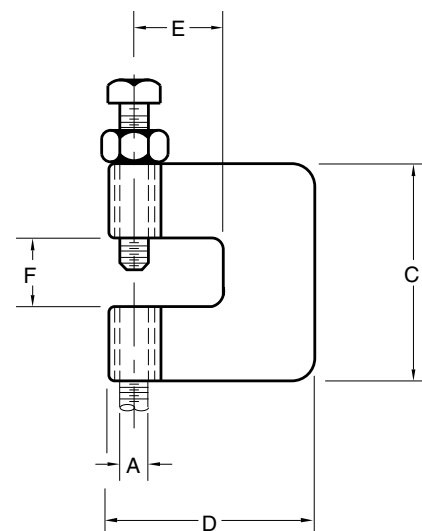

FIGURE 47 – C CLAMP WITH LOCKING NUT

ROD SIZE A	MAX LOAD	C	D	E	F	SET SCREW SIZE	WEIGHT EACH
3/8	400	2 3/4	2 1/4	7/8	3/4	3/8 x 1 1/2	0.38
M10	1779	60	57	22	19	10 x 38	0.17
1/2	500	2 3/4	2 3/8	7/8	3/4	1/2 x 1 1/2	0.38
M12	2224	60	60	22	19	13 x 38	0.17
5/8	600	2 3/4	2 3/4	3/4	3/4	3/8 x 1 1/2	0.68
M16	2669	60	60	19	19	16 x 38	0.31
3/4	800	2 3/4	2 1/4	3/4	3/4	3/8 x 1 1/2	0.79
M20	3559	60	57	19	19	19 x 38	0.36
7/8	1200	3	2 1/4	1 1/4	1	3/8 x 1 1/2	1.83
M20	5338	76	70	32	25	19 x 38	0.83

FIGURE 238 – C CLAMP WITHOUT LOCKING NUT

ROD SIZE A	MAX LOAD	C	D	E	F	SET SCREW SIZE	WEIGHT EACH
3/8	400	2 1/4	2 3/8	7/8	3/4	3/8 x 1 1/2	0.36
M10	1779	57	60	22	19	10 x 38	0.16
1/2	400	2 1/4	2 3/8	7/8	3/4	1/2 x 1 1/2	0.36
M12	1779	57	60	22	19	13 x 38	0.16
5/8	440	2 1/4	2 3/8	3/4	3/4	3/8 x 1 1/2	0.63
M16	1957	57	60	19	19	16 x 38	0.29
3/4	800	2 1/4	2 1/4	3/4	3/4	3/8 x 1 1/2	0.72
M20	3559	57	57	19	19	19 x 38	0.33
7/8	1200	3	2 3/4	1 1/4	1	3/8 x 1 1/2	1.65
M20	5338	76	70	32	25	19 x 38	0.75

DIMENSIONS		TEMPERATURE	LOADS	WEIGHT
INCHES	FAHRENHEIT		POUNDS	POUNDS
MILLIMETERS	CELSIUS		NEWTONS	KILOGRAMS