

MACHINE THREAD EYE ROD

Figure 33 (Right Hand Threads)

Figure 33L (Left Hand Threads)

The Figure 33 is designed to permit swing in the attachment component due to pipe movement. The inside diameter of the eye is $\frac{3}{8}$ " larger than the rod diameter for rod sizes up to 1½" while the inside diameter for larger size rods will be $\frac{3}{4}$ " greater. The eye is not welded. The Figure 93 Welded Eye Rod is available for higher load requirements.

Material: Carbon Steel.

Finish: Plain, Painted, Electro-Galvanized, Hot-Dip Galvanized.

Temperature: 650° F / 343° C Maximum.

Ordering: Specify rod size, rod length, thread length, (if other than standard), figure number, and finish. For Metric applications specify M33 or M33L. Larger rod diameters are available upon request.

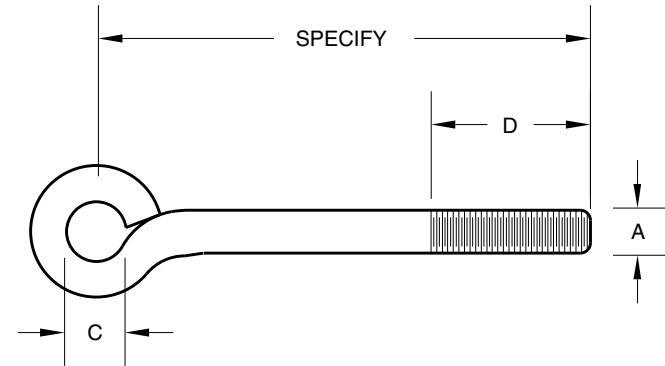

FIGURE 33 – MACHINE THREADED EYE ROD

A	$\frac{3}{8}$	$\frac{1}{2}$	$\frac{5}{8}$	$\frac{3}{4}$	$\frac{7}{8}$	1	1¼	1½	1¾	2	2¼	2½
	M10	M12	M16	M20	M20	M24	M30	M36	M42	M48	M56	M64
C	$\frac{3}{4}$	$\frac{7}{8}$	1	1½	1¾	1¾	1¾	1¾	2½	2¾	3	3¾
	19	22	25	29	32	35	41	48	64	70	76	83
D	2½	2½	2½	3	3½	4	5	6	6	6	6	6
	64	64	64	76	89	102	127	152	152	152	152	152
LOAD AT 650° F / 343° C	240	440	705	1050	1470	1940	3170	4650	6380	8280	10900	13400
	1068	1957	3136	4671	6539	8630	14101	20684	28380	36831	48485	59606