

## 130 CEILING PLATE

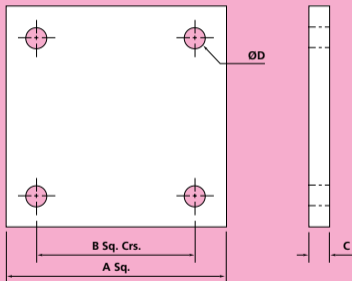

*Material: Carbon Steel*

PART NUMBER	ROD SIZE	A	B	C	D	RECOMMENDED FIXING BOLT	WEIGHT lbs	LOAD CAPACITY		LOAD GROUP
								lbs	kip	
F130_3/8	3/8	5.12	3.94	0.31	0.35	F287-M8/95	2.4	793	0.79	1
F130_1/2	1/2	5.91	4.72	0.31	0.35	F287-M8/95	3	1168	1.17	2
F130_5/8	5/8	6.69	5.51	0.47	0.35	F287-M8/95	5.9	2226	2.23	3
F130_3/4	3/4	7.48	5.91	0.59	0.47	F287-M10/110	9.4	3483	3.48	4
F130_1	1	8.66	7.09	0.79	0.55	F287-M12/145	16.7	5026	5.03	5
F130_1 1/4	1 1/4	10.63	8.66	0.79	0.71	F287-M16/165	25.3	8046	8.05	6
F130_1 1/2	1 1/2	12.6	10.24	0.98	0.87	F287-M20/200	44.3	11772	11.77	7
F130_1 3/4	1 3/4	14.57	11.81	1.18	1.02	F288-M16/50	71.2	16314	16.31	8
F130_2	2	17.72	14.17	1.38	1.22	F288-M20/60	122.7	21274	21.27	9
F130_2 1/4	2 1/4	22.83	18.9	1.57	1.38	F288-M24/60	233	29431	29.43	10
F130_2 1/2	2 1/2	22.83	18.9	1.77	1.38	F289-M205220/60	262.1	39683	39.68	11

FOR USE IN CONJUNCTION WITH PART  
NUMBER 114, 122, 122A OR 125

WHEN ORDERED WITH ONE OF THESE PARTS,  
THIS IS SUPPLIED AS WELDED ASSEMBLY