

## 238 CLEVIS

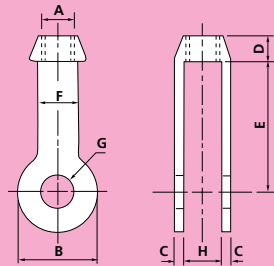

*Material: Forged Steel or Carbon Steel  
This item may be forged or profiled*

PART NUMBER	ROD DIA.	A	B	C	D	E	F	G	H	Wt. lbs.	LOAD CAPACITY		LOAD GROUP
											lbs.	kip	
F238_3/8	3/8	1.5	0.52	1.26	3.75	1.19	0.46	0.71	2.6	793	0.79	1	
F238_1/2	1/2	1.5	0.52	1.26	3.75	1.19	0.58	0.71	2.4	1168	1.17	2	
F238_5/8	5/8	1.5	0.52	1.26	3.75	1.19	0.71	0.71	2.4	2226	2.23	3	
F238_3/4	3/4	2.49	0.63	1.26	4.02	1.19	0.83	0.95	3.9	3483	3.48	4	
F238_1	1	3	0.71	1.26	5	1.5	1.08	1.11	6.3	5026	5.03	5	
F238_1 1/4	1 1/4	3	0.71	1.26	5	1.5	1.08	1.11	6.1	8046	8.05	6	
F238_1 1/2	1 1/2	3.51	0.79	1.62	5.99	1.74	1.33	1.89	10.1	11772	11.77	7	
F238_1 3/4	1 3/4	4.02	0.87	1.74	5.99	1.97	1.58	2.21	13.4	16314	16.31	8	
F238_2	2	5	1.11	2.25	7.01	2.52	1.83	2.29	26.4	21274	21.27	9	
F238_2 1/4	2 1/4	5.99	1.3	2.76	8	3	2.08	2.96	44.9	29431	29.43	10	
F238_2 1/2	2 1/2	5.99	1.3	2.76	8	3	2.33	2.96	43.2	39683	39.68	11	
F238_3	3	5.91	1.5	3.55	7.88	5.91	2.58	3.15	90.6	50761	50.76	12	
F238_3 1/4	3 1/4	7.09	1.58	3.94	7.88	7.09	3.08	3.55	126.3	62005	62.01	13	

## 274 CLEVIS PIN

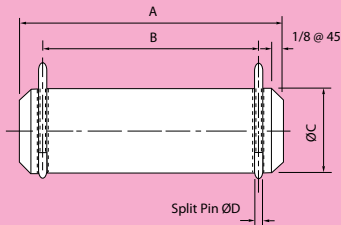

*Material: Carbon Steel*

PART NUMBER	ROD DIA.	A	B	PIN ØC	SPLIT PIN ØD	WEIGHT lbs.	LOAD CAPACITY		LOAD GROUP
							lbs.	kip	
F274_3/8	3/8	2.76	2.17	0.4	0.2	0.1	793	0.79	1
F274_1/2	1/2	2.96	2.37	0.48	0.2	0.1	1168	1.17	2
F274_5/8	5/8	2.96	2.37	0.63	0.2	0.2	2226	2.23	3
F274_3/4	3/4	3.55	2.96	0.79	0.2	0.4	3483	3.48	4
F274_1	1	3.75	3.15	0.95	0.24	0.7	5026	5.03	5
F274_1 1/4	1 1/4	4.14	3.55	1.19	0.24	1.2	8046	8.05	6
F274_1 1/2	1 1/2	4.93	4.34	1.42	0.24	2.2	11772	11.77	7
F274_1 3/4	1 3/4	5.12	4.53	1.66	0.24	3	16314	16.31	8
F274_2	2	5.91	5.12	1.89	0.32	4.6	21274	21.27	9
F274_2 1/4	2 1/4	6.89	6.11	2.21	0.32	7.4	29431	29.43	10
F274_2 1/2	2 1/2	7.29	6.5	2.52	0.32	10.3	39683	39.68	11
F274_3	3	8.08	7.29	2.84	0.32	14.5	50761	50.76	12
F274_3 1/4	3 1/4	8.27	7.49	3.15	0.32	18.2	62005	62.01	13