

281 DUAL FACED ROCKING WASHER

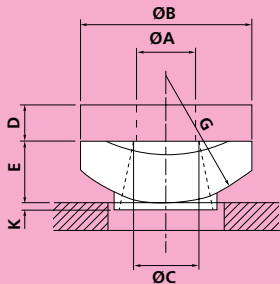

Material: Cast Iron

282 PLATE FOR DUAL FACED ROCKING WASHER

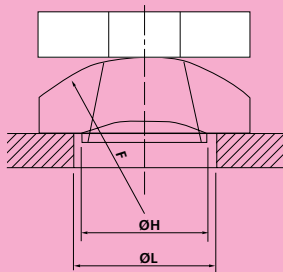

Material: Carbon Steel

PART NUMBER ROCKING WASHER	PART NUMBER PLATE	ROD DIA	A	B	C	D	E	F	G	H	K	L	WEIGHT lbf		LOAD CAPACITY		LOAD GROUP
													ROCKER WASHER	PLATE	lbs	kip	
F281_1/2	F282_1/2	1/2	0.51	1.97	0.77	0.39	0.63	1.26	1.26	1.3	0.2	1.5	0.2	0.3	1168	1.17	2
F281_5/8	F282_5/8	5/8	0.67	1.97	0.77	0.39	0.63	1.26	1.26	1.3	0.2	1.5	0.2	0.3	2226	2.23	3
F281_3/4	F282_3/4	3/4	0.71	2.56	1.1	0.59	0.94	1.89	1.89	1.73	0.2	1.93	0.6	0.7	3483	3.48	4
F281_1	F282_1	1	1.08	2.56	1.1	0.59	0.94	1.89	1.89	1.73	0.2	1.93	0.5	0.7	5026	5.03	5
F281_1 1/4	F282_1 1/4	1 1/4	1.33	3.86	1.57	0.79	1.42	2.83	2.83	2.32	0.2	2.6	2	2.4	8046	8.05	6
F281_1 1/2	F282_1 1/2	1 1/2	1.58	3.86	1.57	0.79	1.42	2.83	2.83	2.32	0.2	2.6	2	2.2	11772	11.77	7
F281_1 3/4	F282_1 3/4	1 3/4	1.83	4.49	1.81	0.98	1.65	3.31	3.31	2.64	0.24	2.91	3	3.7	16314	16.31	8
F281_2	F282_2	2	2.08	5.12	2.05	1.18	1.89	3.78	3.78	2.95	0.28	3.23	4.6	5.7	21274	21.27	9
F281_2 1/4	F282_2 1/4	2 1/4	2.33	5.94	2.36	1.38	2.2	4.41	4.41	3.5	0.31	3.66	7.2	9	29431	29.43	10
F281_2 1/2	F282_2 1/2	2 1/2	2.33	6.81	2.72	1.57	2.52	5.04	5.04	3.78	0.39	4.09	11	13.6	39683	39.68	11